

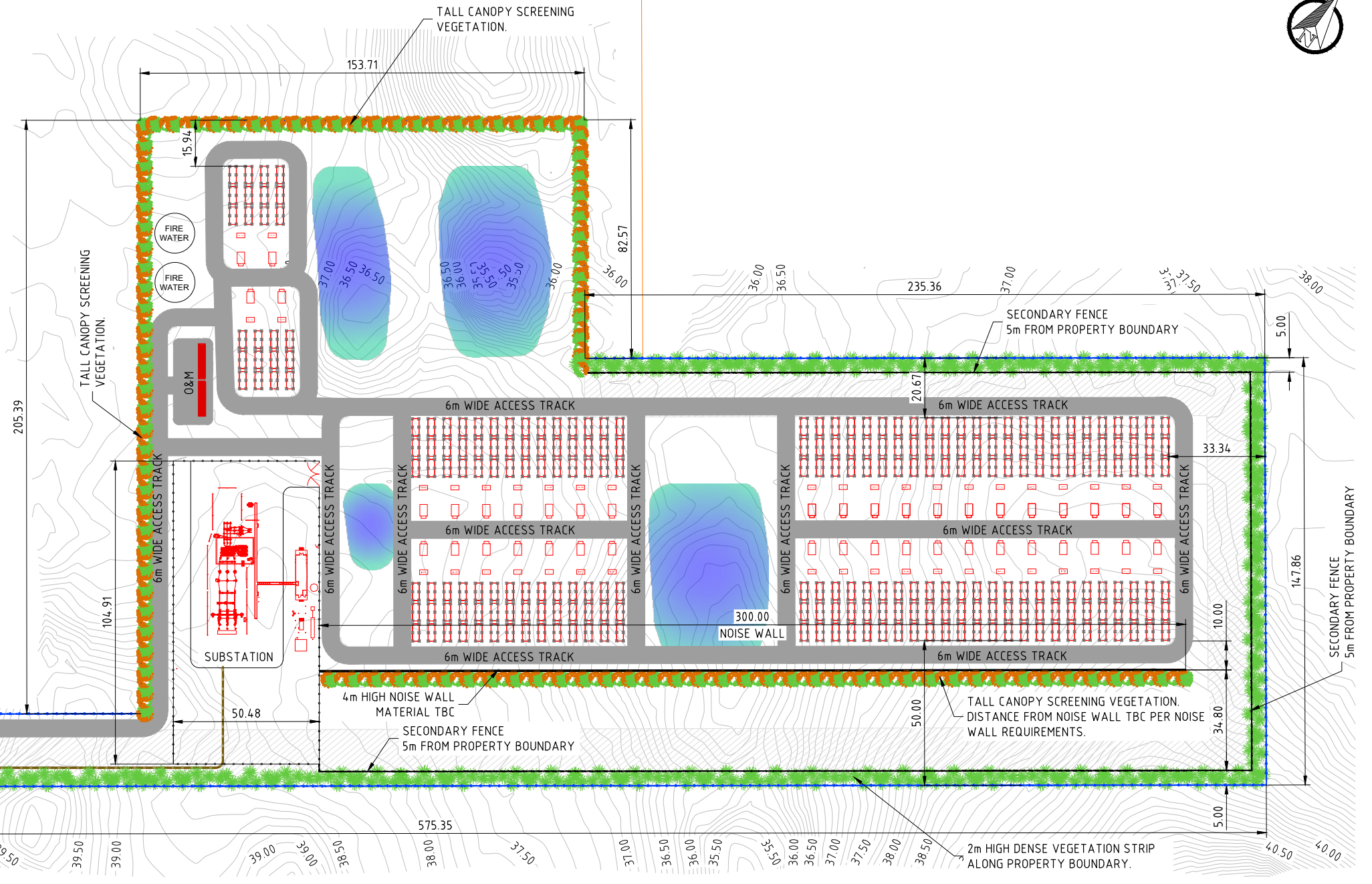

KEY PLAN



LEGEND

	6m ROAD
	SITE BOUNDARY FENCE
	POWER CONVERSION UNIT
	INVERTER BLOCK
	BATTERY BLOCK
	FIRE WATER TANK
	20m BUFFER
	EXCLUSION ZONE INDICATIVE OF WATER PASSAGEWAYS INTO DISSOLUTION ZONE AS PER GEOPHYSICAL REPORT

BESS SPECIFICATIONS	
DESCRIPTION	QTY
RATED POWER (MW)	159.6
RATED ENERGY (MWh)	657.3
USEFUL POWER (MW)	127.68
USEFUL ENERGY (MWh)	525.84
BESS DURATION	4h
BESS CONTAINER MODULE	SAFT I-Shift
NUMBER OF BESS CONTAINERS	252
BESS CONTAINER CAPACITY (MWh)	2.6083
POWER CONVERSION EQUIPMENT	SMA SCS 3800 UP-XT
NUMBER OF POWER CONVERSION EQUIPMENT	42
POWER CONVERSION EQUIPMENT POWER (MW)	3.8

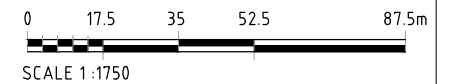

Enhar Pty Ltd.
Suite G02 60 Leicester St, Carlton VIC 3053
www.enhar.com.au

NOTES:

This drawing has been prepared exclusively for the purpose described in the client brief and the Enhar quotation. It is not to be used for any other purpose and Enhar Pty. Ltd. accepts no liability for the improper use of this drawing. The drawing relies on input data provided by the client and third parties and Enhar accepts no liability for omissions or errors in the input data. Always confirm dimensions and details on site prior to using any information contained herewith. All dimensions and details are indicative only, and based on visual not intrusive inspection and require confirmation on site.

#	CONCEPT	JB	AM	07/06/2024
REV	REVISION DESCRIPTION	DRWN BY	CHKD BY	DATE

PROJECT TITLE:	125MW / 500MWH BLANCHE BESS	STATUS:	CONCEPT
PROJECT LOCATION:	25 Mckay Road, Compton SA 5291	SCALE:	NTS
DRAWING TITLE:	BESS LAYOUT	REVISION:	A
PROJECT CODE:	J00847	DWG NUMBER:	J00847-DWG-CIV-GEN-001
		SHEET SIZE:	A3